

Compression Load Point Assemblies

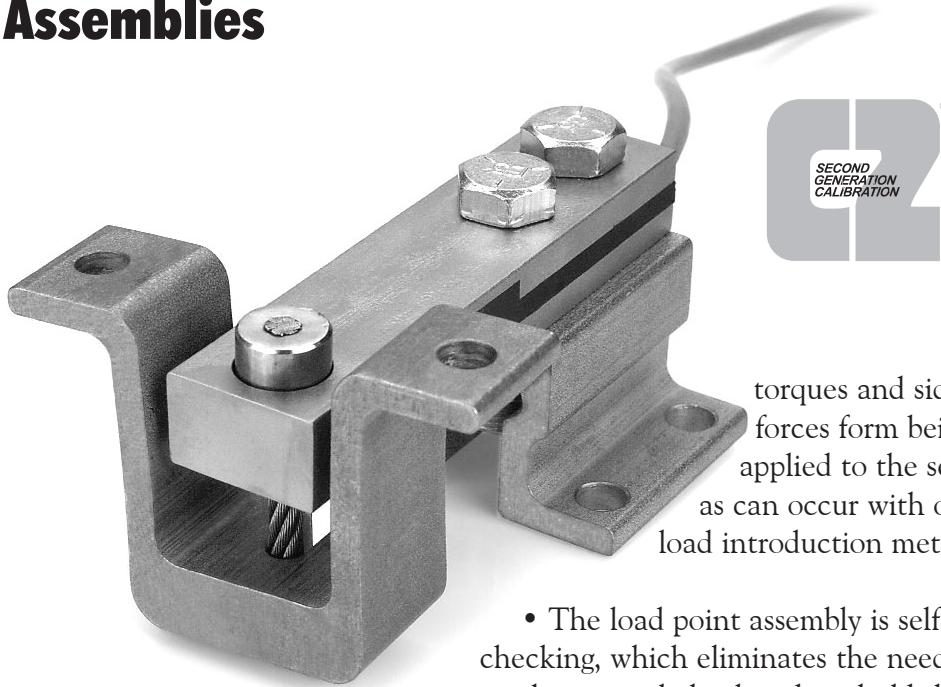

The Hardy Instruments ADVANTAGE™ LITE series of load point assemblies provides superior performance when compared to common load cells, as well as exceptional value, in meeting your weighing needs. All ADVANTAGE™ LITE load points include these beneficial features:

- Each pre-assembled load point consists of stainless steel mounting hardware and a C2® compatible stainless steel, matched, and sealed load sensor to resist corrosion and provide years of dependable performance.
- It is free floating and self-centering, to allow the vessel to expand and contract while the load is constantly applied to the same point on the sensor. This helps provide an accurate and consistent weight signal, and avoids

torques and side forces from being applied to the sensor, as can occur with other load introduction methods.

- The load point assembly is self-checking, which eliminates the need for costly external check rods to hold the assembly in place.
- The orientation of the load point assembly is non-restricted. This means its positioning is not limited to one or two directions, enabling you to install it in tight areas with very little clearance, without affecting its performance.
- Each load sensor comes with twenty feet of six-conductor cable and a color-coded wiring label to aid in installation. The performance characteristics of the load sensor are also stored in an internal memory device. A Hardy Instruments C2® certified controller uses these parameters, its internal characteristics and a reference point to electronically calibrate the system. C2® calibration reduces downtime for installation and repairs, while eliminating the need and cost for heavy test weights, that can lead to delays and weight handling related injuries.

ADVANTAGE™ LITE Series

Applications

- Tank, Hopper, and Vessel Weighing
- Process Measurement
- Batch Weighing

Features

- Free Floating
- Free Positioning
- C2®, Second Generation Calibration
- All Stainless Steel
- Exceptional Value
- Matched Performance

**HARDY
INSTRUMENTS**

COMPONENTS TO COMPLETE YOUR HARDY INSTRUMENTS SYSTEM FOR:

- Filling & Dispensing
- IBC Dispensing
- Batching/Blending
- Check Weighing
- Flow Rate Monitoring
- Flow Rate Control
- Force Measurement
- Level Measurement/Control
- Weighing Instruments Dedicated to Your Applications: Controllers, Weigh Modules, Transmitters



• Communication Interfaces

Allen-Bradley PLC®, ControlLogix®, SLC®, DeviceNet®, Remote I/O, Profibus, Analog, and Serial.



• C2® Certified Cable

This 8-conductor cable is specifically designed for reliable communication of weight and C2 data from the junction box to the instrument.

• Integrated Technician Junction Box

This Nema 4 rated waterproof enclosure sums load sensor signals and contains circuitry to

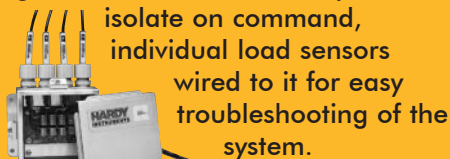

isolate on command, individual load sensors wired to it for easy troubleshooting of the system.

HARDY INSTRUMENTS

ADVANTAGE LITE™ LOAD POINT OUTLINE

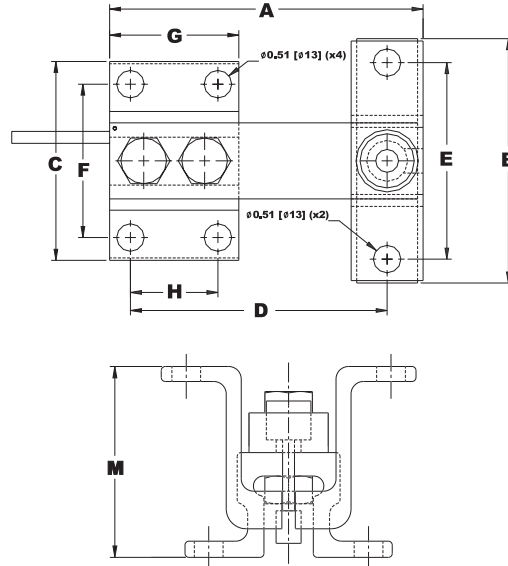

DIMENSIONS: INCHES & (mm)

Inches (mm)	Capacity	
	1.1K lb. & 2.2K lb. (500kg & 1000kg)	4.4K lb. (2000kg)
A	5.06 (128.6)	5.06 (128.6)
B	4.02 (102)	4.02 (102)
C	3.27 (83.0)	3.27 (83.0)
D	4.22 (107.1)	4.22 (107.1)
E	3.23 (82.0)	3.23 (82.0)
F	2.52 (64.0)	2.52 (64.0)
G	2.12 (53.9)	2.12 (53.9)
H	1.44 (36.5)	1.44 (36.5)
M	3.01 (76.5)	4.00 (101.6)

To learn more about the ADVANTAGE™ LITE Series, visit our web site to find:

- full product specifications
- ordering information
- application notes
- technical description
- downloadable installation sheet

www.hardyinst.com

or call us at

800-821-5831, ext. 34

SPECIFICATIONS

Parameters	ADVANTAGE LITE	ADVANTAGE
LC Metal	Stainless Steel	Stainless Steel
Sealing Method	Potted	True Hermetic***
Wash Down	IP67	IP68
Mount Metal	Stainless Steel	Stainless Steel
Rated Capacities	1.1K, 2.2K & 4.4K lb. 500, 1000, 2000 kg	44 through 200K lb. 20 through 90 mt
C2® Electronic Calibration	Yes	Yes
Conduit Hub	No	Yes
Ground Strap	No	Yes
Matched mV/V/Ohm**	Yes	Yes
Published Performance Program	No	Yes
Shipped Assembled	Yes	Yes
Load Introduction	Wire Rope	Teflon Load Pin
Rated Output mV/V	2 +/- 0.004	2 +/- 0.002
Hysteresis	< +/- 0.025%	< +/- 0.025%
Non-Linearity	< +/- 0.025%	< +/- 0.018%
Temperature Effect on Minimum Dead Load Output % Rated Output/C°	< +/- 0.002	< +/- 0.001
Temperature Effect on Rated Output %/C°	< +/- 0.002	< +/- 0.001
Zero Balance % Rated Output	< +/- 1.0	< +/- 1.0
Compensated Temperature Range C°	-10 ... +40	-10 ... +40
Operational Temperature Range C°	-40 ... +80	-40 ... +80
Safe Overload	150% Capacity	200% Capacity
Ultimate Overload	> 150% Capacity	300% Capacity
Input Resistance	1146 +/- 4.36% Ohms	1106 +/- 0.045% Ohms
Output Resistance	1001 +/- 1.0% Ohms	1000 +/- 0.10% Ohms

*Published Performance Program allows ADVANTAGE certification sheets to be viewed and downloaded from the Hardy Instruments web site 24/7.

**Most load cells are calibrated in mV/V units and must be "corner adjusted" when used in multiple cell system. Hardy ADVANTAGE sensors are calibrated for mV/V/Ohm and mV/V, which results in "cornering" without adjustment, and may eliminate the need for re-calibration after field replacement.

***The sensor is totally hermetically sealed. This includes the gauged area and the cable entry.

ORDERING INFORMATION

CAPACITY

lb.	kg
1100	500
2200	1000
4400	2000

Load Point

Model Number

HI LPWR1.1K-33C
HI LPWR2.2K-33C
HI LPWR4.4K-33C

Hardy Instruments

3860 Calle Fortunada
San Diego, CA 92123-1825
tel. 800-821-5831 • tel. 858-278-2900
fax 858-278-6700
www.hardyinst.com • info@hardyinst.com

ISO 9001
CERTIFIED
Since 1993

HI LPWR

www.hardyinst.com • 800-821-5831